

Z:\project\2443.01 Hb Haines Lutak Dock Study\Civil\ACAD\2443.01 - C1.2 Alternative 1 Plan & Section.dwg

Plotted 12/23/2016 9:38 AM by Jean Cumlat

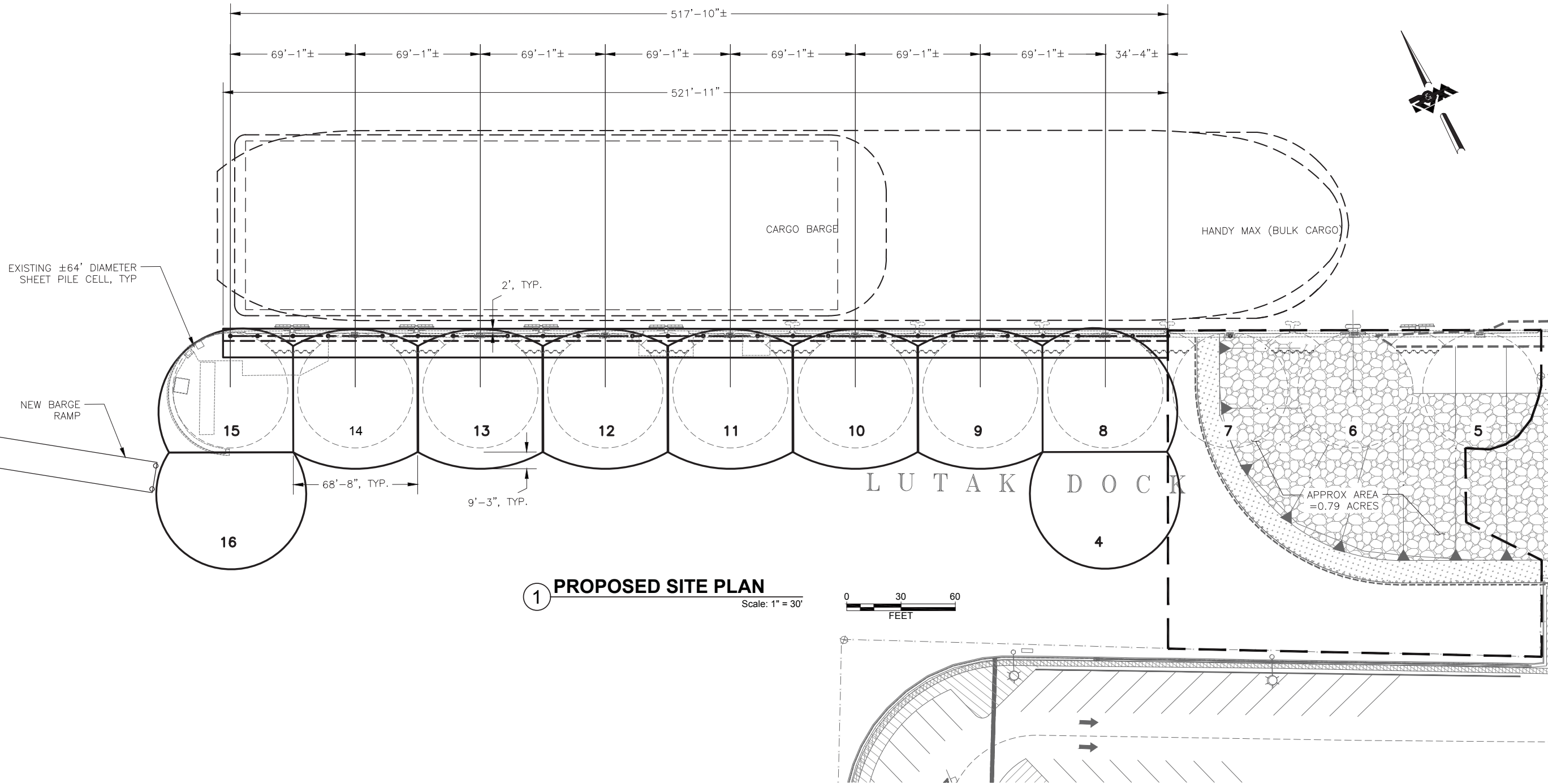

1 PROPOSED SITE PLAN

Scale: 1" = 30'



PROGRESS SET  
NOT FOR  
CONSTRUCTION

**R&M CONSULTANTS, INC.**  
 9101 Vanguard Drive  
 Anchorage, Alaska 99507  
 rmconsult.com • email: rmc@rmconsult.com  
 phone: 907.522.1707 • fax: 907.522.3403

**R&M**

CORPORATE AUTHORIZATION NUMBER AEC0111

**Haines Borough**  
 LUTAK DOCK STUDY

No.	Description	Date

Drawn By: PMH/JVC  
 Checked By: JD/DA  
 Date: DEC 23, 2016  
 Project: PRELIMINARY  
 Project No: 2443.01

SHEET TITLE:  
 ALTERNATIVE 1B - PLAN

SHEET NO:  
 9 OF 27  
**C1.3**